

## The mill - granulator G 200/300

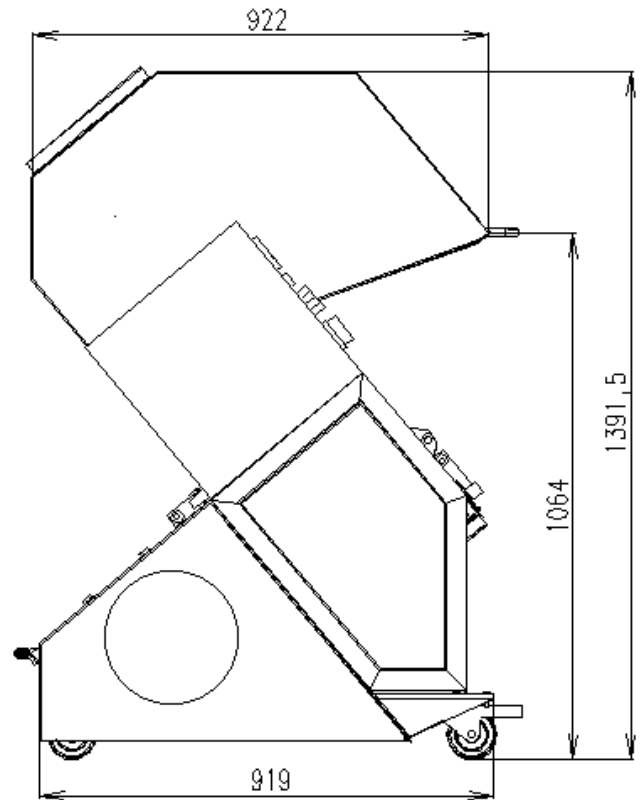
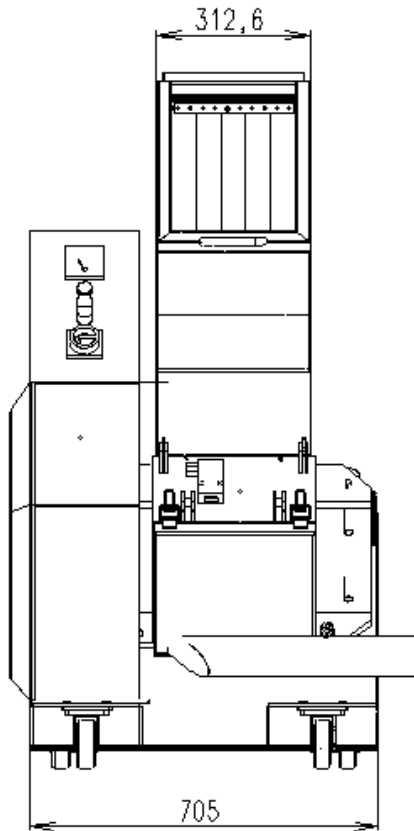

### Features:

- ideal for recycling plastic, rubber, textile and similar waste
- overload control (electrical and mechanical)
- easy cleaning when changing material
- optimum granulate quality

### Technical parameters:

- |                  |                  |
|------------------|------------------|
| -diam. of rotor  | 200 [mm]         |
| -length of rotor | 300 [mm]         |
| -power           | 4,5.5 [kW]       |
| -weight          | 200 [kg]         |
| -throughput      | 30 - 80[kg/hour] |